

# HP Laserjet m608

IP Address | Configuration Report Page | Basic Driver

## IP Address

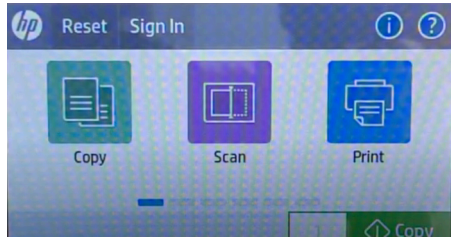

From the main screen, swipe down to display the network information

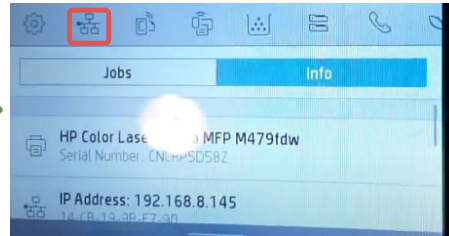

On the next screen, tap the Ethernet icon

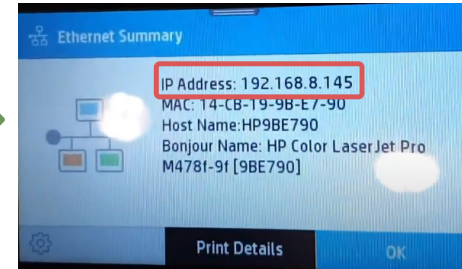

The IP Address should appear on the 'Ethernet Summary' screen.

## Print Configuration Report

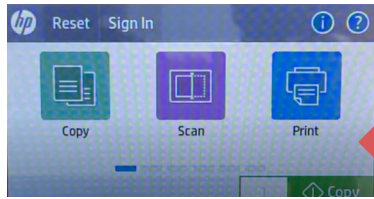

From the main screen, swipe to the left until you see the 'Reports' option (in the 3rd section).

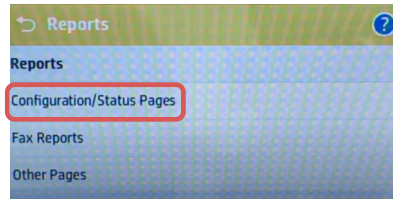
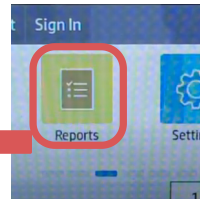

On 'Reports', select 'Configuration/StatusPages.'

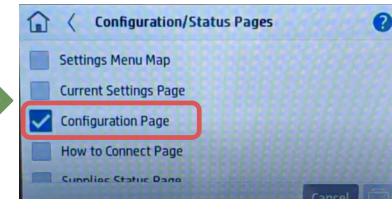

Select 'Configuration Page' and tap the Print Icon when you will see the 'Preparing Job' prompt at the top

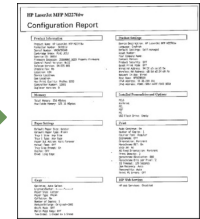

Locate the IPv4 Address on the page 10.102.34.567