

HP Laserjet M52645

IP Address | Configuration Report Page | Basic Driver

IP Address

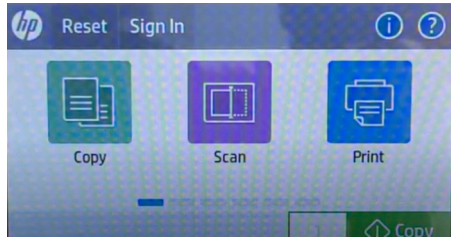

From the main screen, swipe down to display the network information

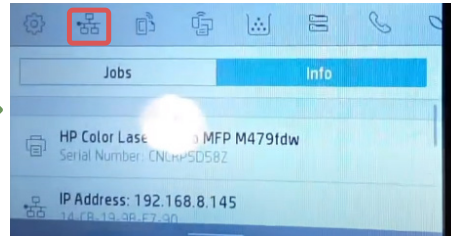

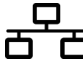
On the next screen, tap the Ethernet icon 

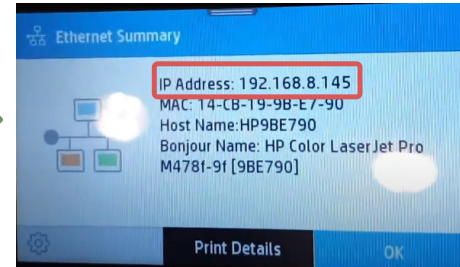

The IP Address should appear on the 'Ethernet Summary' screen.

Print Configuration Report

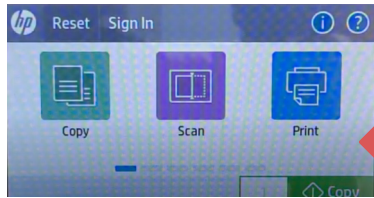

From the main screen, swipe to the left until you see the 'Reports' option (in the 3rd section).

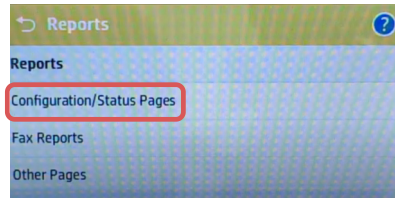
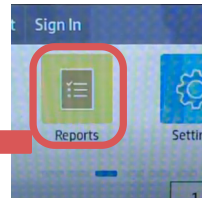

On 'Reports', select 'Configuration/StatusPages.'

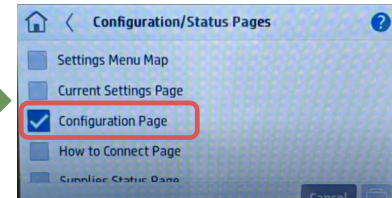

Select 'Configuration Page' and tap the Print Icon  then you will see the 'Preparing Job' prompt at the top

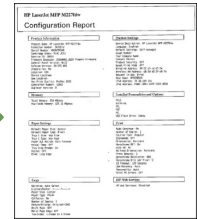

Locate the IPv4 Address on the page 10.102.34.567