

IP Address

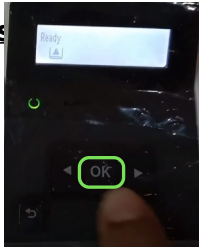

At the main screen that displays 'ready,' hit 'OK'

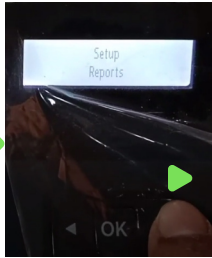

Arrow over until you see 'Network Set up' then hit the 'OK' button.

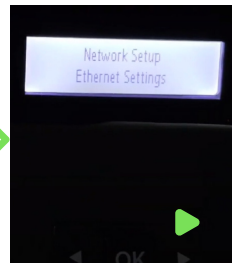

Arrow over until you see 'General Settings,' then hit 'OK.'

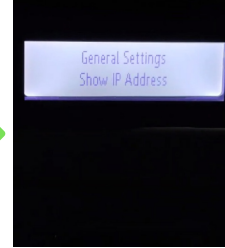
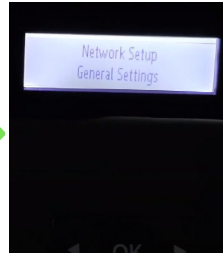

With 'General Settings' showing, hit the 'OK' button again to display 'Show IP Address.'

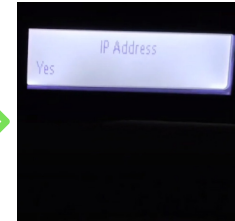

Tap the 'OK' button again at the 'YES' prompt

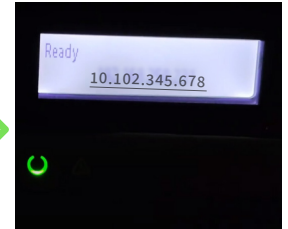

Your Printer's IPv4 address should appear.

Print Configuration Report

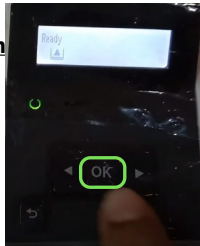

At the main screen that displays 'ready,' hit 'OK' and select 'Setup.'

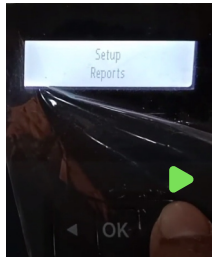

Arrow over until you see 'Reports' then hit the 'OK' button.

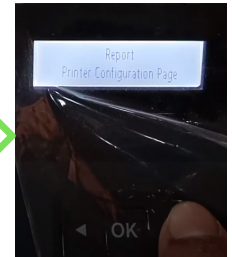

Arrow over again until you see 'Printer Configuration Page' option then hit the 'OK' button.



After you tap 'OK,' the dialogue 'Printing..' should appear